

REVISIONS		
DATE	NAME	LIC. NO.

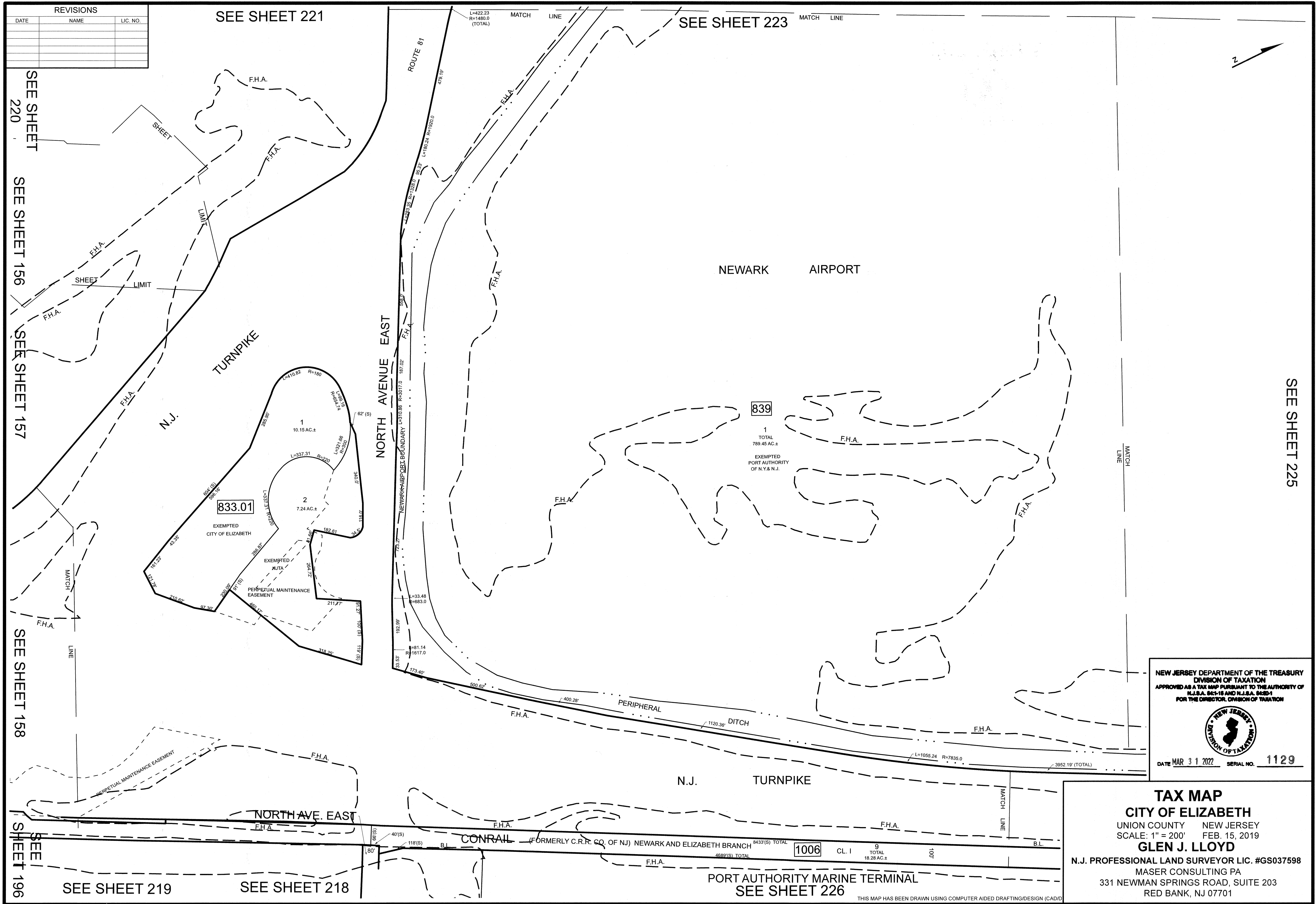

SEE SHEET 220
SEE SHEET 156
SEE SHEET 157
SEE SHEET 158
SEE SHEET 196

SEE SHEET 221

SEE SHEET 223

SEE SHEET 225

SEE SHEET 219

SEE SHEET 218

PORT AUTHORITY MARINE TERMINAL
SEE SHEET 226

NEW JERSEY DEPARTMENT OF THE TREASURY
DIVISION OF TAXATION
APPROVED AS A TAX MAP PURSUANT TO THE AUTHORITY OF
N.J.S.A. 84:1-18 AND N.J.S.A. 84:2D-1
FOR THE DIRECTOR, DIVISION OF TAXATION



DATE MAR 31 2022 SERIAL NO. 1129

TAX MAP
CITY OF ELIZABETH
UNION COUNTY NEW JERSEY
SCALE: 1" = 200' FEB. 15, 2019
GLEN J. LLOYD
N.J. PROFESSIONAL LAND SURVEYOR LIC. #GS037598
MASER CONSULTING PA
331 NEWMAN SPRINGS ROAD, SUITE 203
RED BANK, NJ 07701

THIS MAP HAS BEEN DRAWN USING COMPUTER AIDED DRAFTING/DESIGN (CAD)