

REVISIONS		
DATE	NAME	LIC. NO.



SEE SHEET 160  
DOWD AVE

NEW JERSEY

TURNPIKE

AUTHORITY

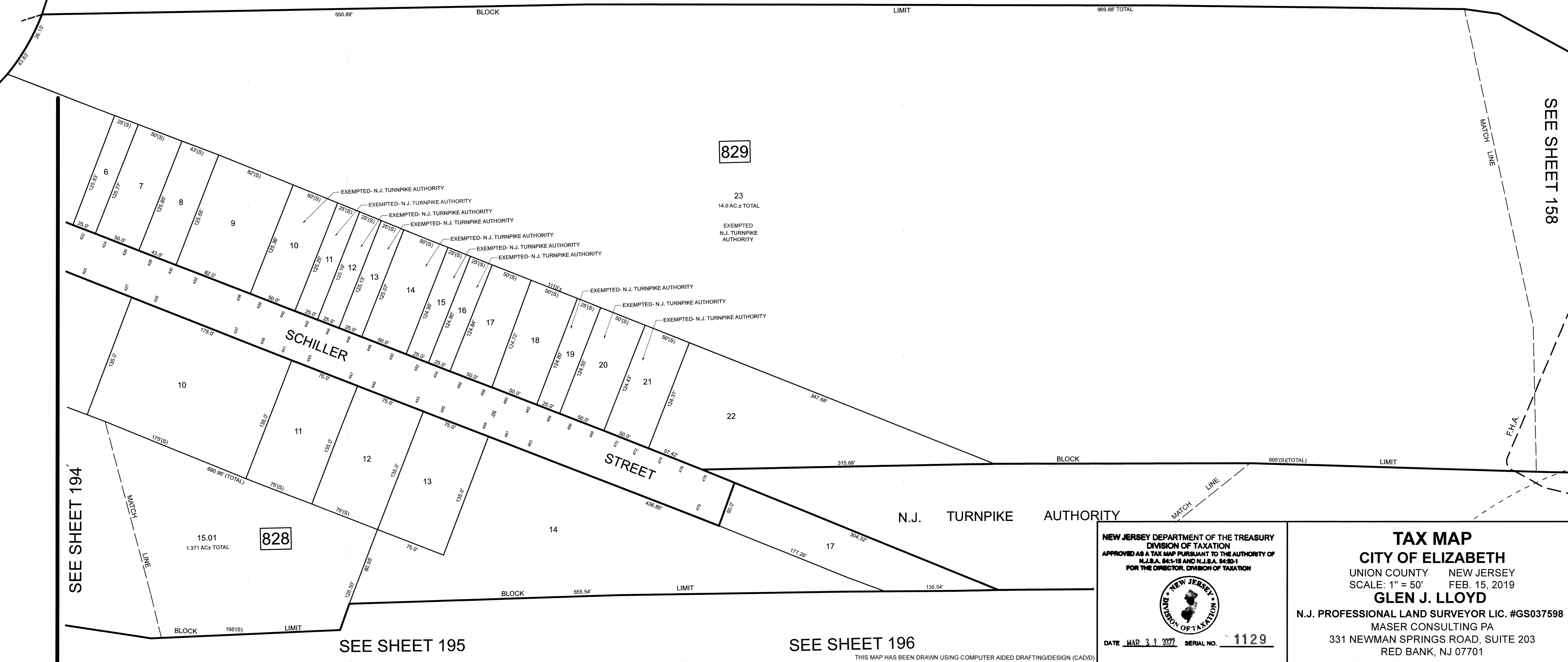

SEE SHEET 194

SEE SHEET 158

SEE SHEET 195

SEE SHEET 196

NEW JERSEY DEPARTMENT OF THE TREASURY  
DIVISION OF TAXATION  
APPROVED AS A TAX MAP PURSUANT TO THE AUTHORITY OF  
N.J.S.A. 84:1-18 AND N.J.S.A. 84:20-1  
FOR THE DIRECTOR, DIVISION OF TAXATION



DATE MAR 31 2017 SERIAL NO. 1129

**TAX MAP**  
**CITY OF ELIZABETH**  
UNION COUNTY NEW JERSEY  
SCALE: 1" = 50' FEB. 15, 2019  
**GLEN J. LLOYD**  
N.J. PROFESSIONAL LAND SURVEYOR LIC. #GS037598  
MASER CONSULTING PA  
331 NEWMAN SPRINGS ROAD, SUITE 203  
RED BANK, NJ 07701