

REVISIONS		
DATE	NAME	LIC. NO.

KEY SHEET 3

KEY SHEET 4

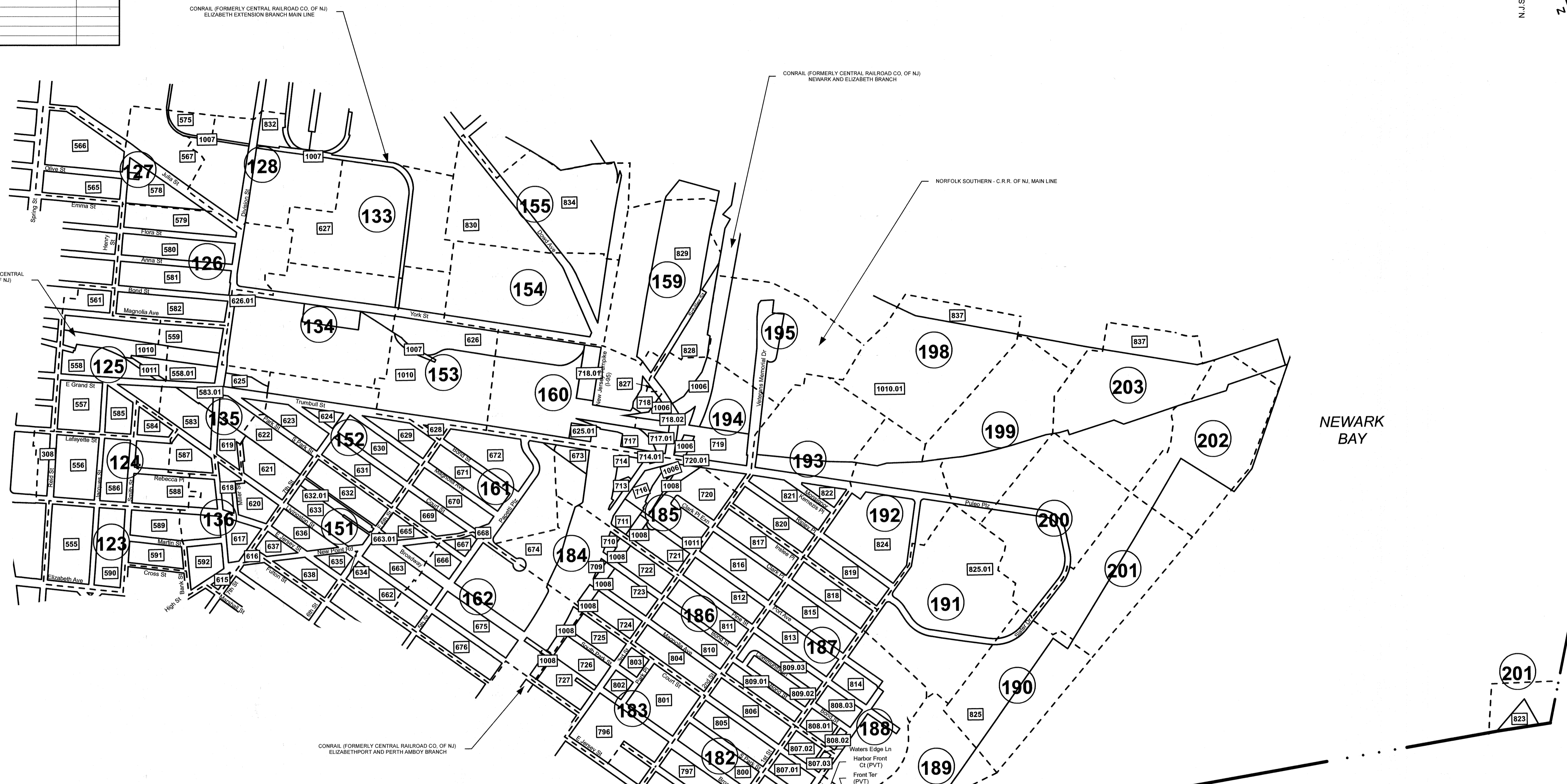

KEY SHEET 2

LEGEND

- STATE BOUNDARY LINE
- COUNTY BOUNDARY LINE
- MUNICIPAL BOUNDARY LINE
- SHEET LIMIT LINE
- BLOCK LIMIT LINE

- 01 DETAIL SHEET NUMBERS ON KEY MAP
- 973 BLOCK NUMBERS ON KEY MAP

KEY SHEET 5

THIS MAP HAS BEEN DRAWN USING COMPUTER AIDED DRAFTING/DESIGN (CAD/D)

NEW JERSEY DEPARTMENT OF THE TREASURY
 DIVISION OF TAXATION
 APPROVED AS A TAX MAP PURSUANT TO THE AUTHORITY OF
 N.J.S.A. 54:1-18 AND N.J.S.A. 54:25-1
 FOR THE DIRECTOR, DIVISION OF TAXATION

DATE MAR 31 2022 SERIAL NO. 1129

TAX MAP
CITY OF ELIZABETH
 UNION COUNTY NEW JERSEY
 SCALE: 1" = 500' FEB. 15, 2019
GLEN J. LLOYD
 N.J. PROFESSIONAL LAND SURVEYOR LIC. #GS037598
 MASER CONSULTING PA
 331 NEWMAN SPRINGS ROAD, SUITE 203
 RED BANK, NJ 07701