

BICYCLE SHELTER AMENITIES LAYOUT ENLARGEMENT PLAN
N.T.S.

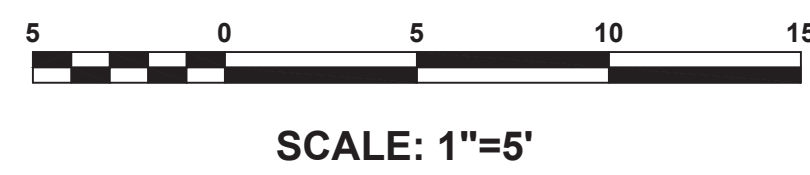

E:\SCE\Elizabeth\10509.021 - Elizabeth\Sheets\10509.021 04 Site Layout Plan.dwg Thu, Feb 11, 2021 - 7:57am kkemper - SUBURBAN CONSULTING ENGINEERS, INC.

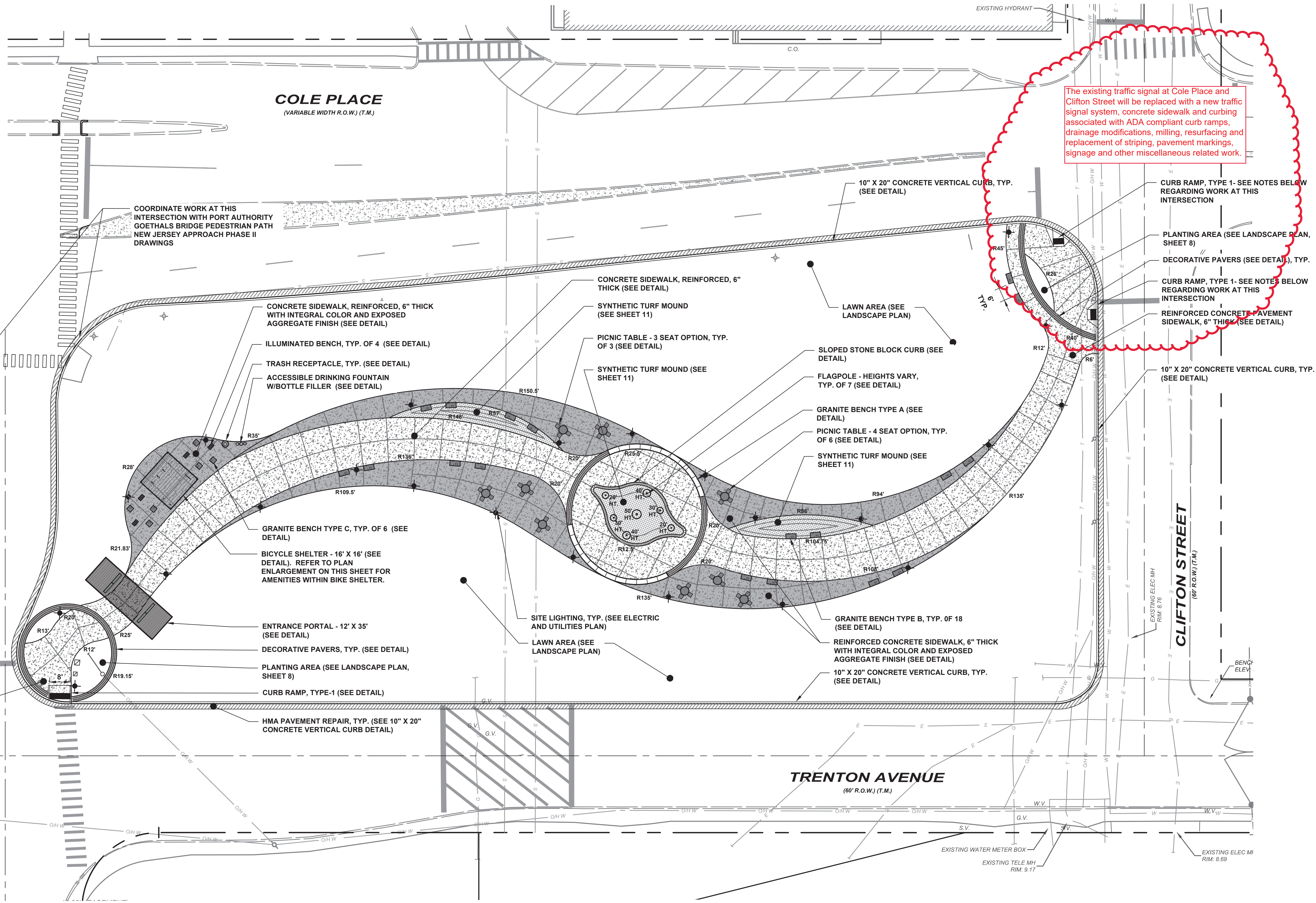

The existing traffic signal at Cole Place and Clifton Street will be replaced with a new traffic signal system, concrete sidewalk and curbing associated with ADA compliant curb ramps, drainage modifications, milling, resurfacing and replacement of striping, pavement markings, signage and other miscellaneous related work.

ADVISORY NOTES TO CONTRACTOR:

- FOR ALL WORK AT THE INTERSECTION OF CLIFTON STREET AND COLE PLACE, CONTRACTOR SHALL REFER TO SHEETS 1-14 OF ELIZABETH RIVER TRAIL PHASE 5 - EXTENSION (COLE PLACE & CLIFTON STREET - TRAFFIC SIGNAL IMPROVEMENT PLANS PREPARED BY JOHNSON, MIRMIRAN & THOMPSON AND INCLUDED IN THIS PLAN SET.
- CONTRACTOR SHALL ALSO COORDINATE WORK AT THE INTERSECTION OF BAYWAY AVENUE AND COLE PLACE WITH PORT AUTHORITY GOETHALS BRIDGE

PEDESTRIAN PATH NEW JERSEY APPROACH PHASE II. PAVEMENT MARKINGS AT THIS INTERSECTION PART OF PORT AUTHORITY PROJECT.

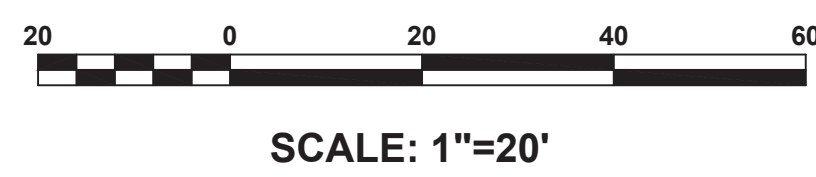
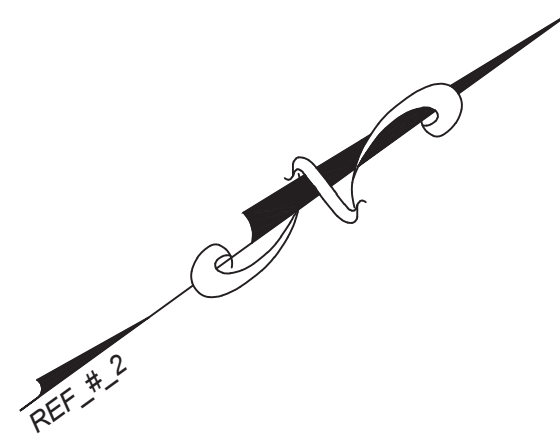

NOTICE
THIS DRAWING AND ALL INFORMATION CONTAINED HEREIN IS AUTHORIZED FOR USE ONLY BY THE PARTY FOR WHOM THE WORK WAS CONTRACTED OR TO WHOM IT IS CERTIFIED. THIS DRAWING MAY NOT BE COPIED, REPRODUCED, DISCLOSED, DISTRIBUTED, OR BELIEVED UPON FOR ANY OTHER PURPOSE WITHOUT THE WRITTEN CONSENT OF SUBURBAN CONSULTING ENGINEERS, INC. PER N.J.A.C. ELECTRONIC SUBMISSIONS NOT CONTAINING A VALID DIGITAL SEAL OR PAPER COPIES NOT CONTAINING A RAISED SEAL ARE NOT ORIGINALS AND MAY HAVE BEEN ALTERED. © COPYRIGHT 2021 SUBURBAN CONSULTING ENGINEERS, INC.™ ALL RIGHTS RESERVED

REVISED PER NJDOT COMMENTS	A	01/22/2021	KAK	RG
DESCRIPTION	NO.	DATE:	BY:	CHK:
REVISIONS				

DRAWN BY: KAK 12/16/2020
CHECKED BY: RG 12/15/2020
CHECKED BY:

DAREN J. PHIL, PE
NJ PROFESSIONAL ENGINEER
LICENSE NO. 24GE03619100

DATE: 12/15/2020

SE SUBURBAN CONSULTING ENGINEERS, INC.
COA NO: 24C/A2807500
270110004200

- Civil Engineers - Municipal Engineers
- Landscape Architects -
- Planners - Environmentalists - Land Surveyors -

96 US Highway 206, Suite 101 2430 Highway 34, Bldg. A Suite 1R
Flanders, NJ 07836 - 973.398.1776 Wall, NJ 08736 - 732.282.1776

EXCELLENCE ♦ ECONOMY ♦ ENVIRONMENT

CONSTRUCTION PLANS FOR ELIZABETH RIVER TRAIL EXTENSION BLOCK 4 LOT 1598-A
CITY OF ELIZABETH, COUNTY OF UNION, STATE OF NEW JERSEY

SITE LAYOUT PLAN

PROJECT NUMBER: 10509.021
SCALE: 1" = 20'
SHEET 4 OF 16
REVISION A