

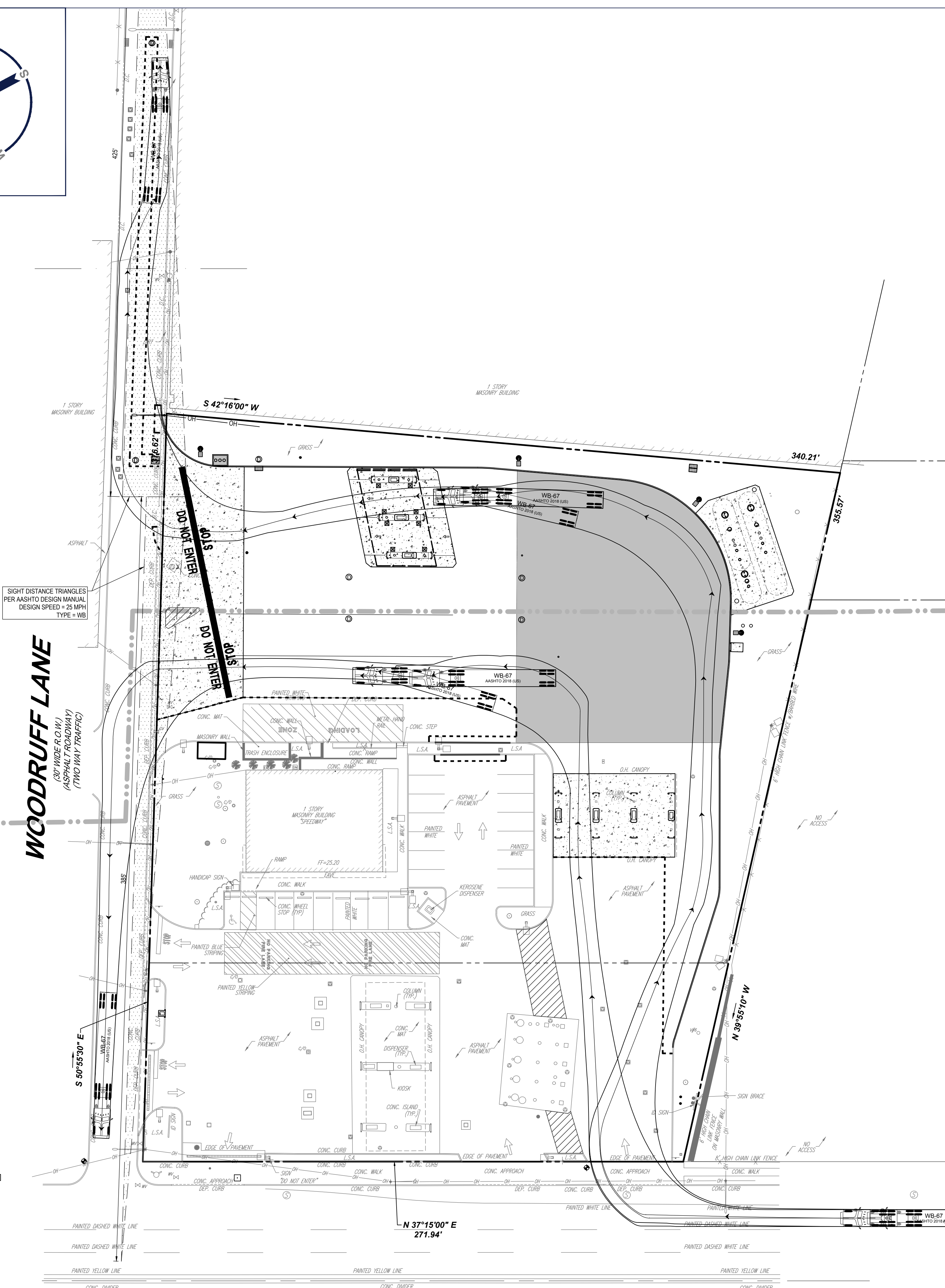

XXXX



WOODRUFF LANE
(30' WIDE R.O.W.)
(ASPH. ROADWAY)
(TWO WAY TRAFFIC)

N 37°15'00" E
271.94'

SPRING STREET
(A.K.A. NEW JERSEY STATE HIGHWAY ROUTE 1 & 9)
(F.K.A. STATE HIGHWAY ROUTE NO. 25)
(120' WIDE R.O.W.) (ASPH. ROADWAY) (TWO WAY TRAFFIC)

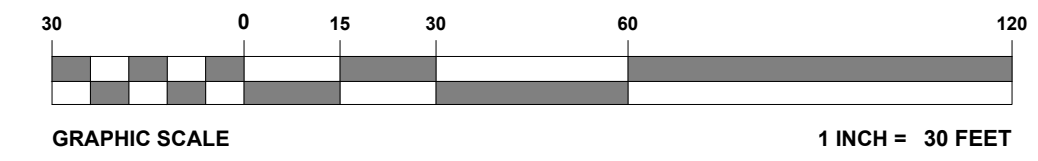

A-4

811
Know what's below.
Call before you dig.
NEW JERSEY
YOU MUST CALL 811 BEFORE ANY EXCAVATION
WHETHER IT'S ON PRIVATE OR PUBLIC LAND.
1-800-272-1000
www.nj-811.org

ISSUED FOR MUNICIPAL &
AGENCY REVIEW & APPROVAL

| NO. | REVISIONS | DATE | DESIGNER | PROJ. MGR. | REVIEWER |
|-----|--------------------------|---------|----------|------------|----------|
| 1 | REV. PER CLIENT COMMENTS | 3/11/20 | JT | JK | JK |
| 2 | REV. PER CLIENT COMMENTS | 3/19/20 | JT | JK | JK |
| 3 | REV. PER CLIENT COMMENTS | 7/20/20 | JT | JK | JK |
| 4 | REV. PER CLIENT COMMENTS | 8/05/20 | JT | JK | JK |

**PROPOSED TRUCK
CIRCULATION EXHIBIT**

LOCATION OF SITE:
623 SPRING STREET
ELIZABETH,
UNION COUNTY, NJ 07201

| | |
|-----------------------|--------------|
| APPLICATION NO. | Z-04-20 |
| STORE OR BLDG NO. | # 0003495 |
| VERSION OR PROJECT ID | J190876 |
| DESIGN TEAM | DATE |
| DGNR. | GS 03-04-20 |
| P.MGR. | BE 03-04-20 |
| RVWR. | RLS 03-04-20 |
| DWG. NO. | EX-01 |

BOHLER
BOHLER ENGINEERING, LLC
35 TECHNOLOGY DRIVE
WARREN, NJ 07089
Phone: (908) 975-5300
Fax: (908) 975-5301
www.BohlerEngineering.com
NJ LICENSE OF AUTHORIZATION NO. 14A362811712 & 14A4010122

R.L. STREKER
PROFESSIONAL ENGINEER
NEW JERSEY LICENSE No. 45344
NEW YORK LICENSE No. 079632

Prepared By:
Speedway
Engineering and Construction
Dept. Enron, OH 45323

Speedway